

AN ADDITIONAL 2NO EXISTING CAMERAS ARE LOCATED WITHIN CHURCH COTTAGE

INTRUDER ALARM	
⊠	INTRUDER ALARM HEAD END EQUIPMENT.
◇	INTRUDER ALARM SYSTEM WIRELESS DOOR CONTACT
⊠	INTRUDER ALARM KEY PAD, FOB CONTROL WITH PIN ENTRY FACILITY AND DURESS CODE FUNCTION.
⊠	90 DEGREE WIRELESS PRESENCE DETECTOR. DUAL TECHNOLOGY, ANTI-MASKING
⊠	360° WIRELESS PRESENCE DETECTOR. DUAL TECHNOLOGY, ANTI-MASKING
⊠	WIRELESS BREAKING GLASS / VIBRATION SENSOR
⊠	SAFE LIMPET

CCTV	
⊠	FIXED DOME / TURRET CAMERA, SURFACE MOUNTED. BY HIKVISION EXISTING / NEW AS NOTED.
⊠	BRACKET MOUNTED EXTERNAL CAMERA. BY HIKVISION EXISTING / NEW AS NOTED.
⊠	EXISTING REPOSITIONED CCTV MONITORING EQUIPMENT, BY HIKVISION

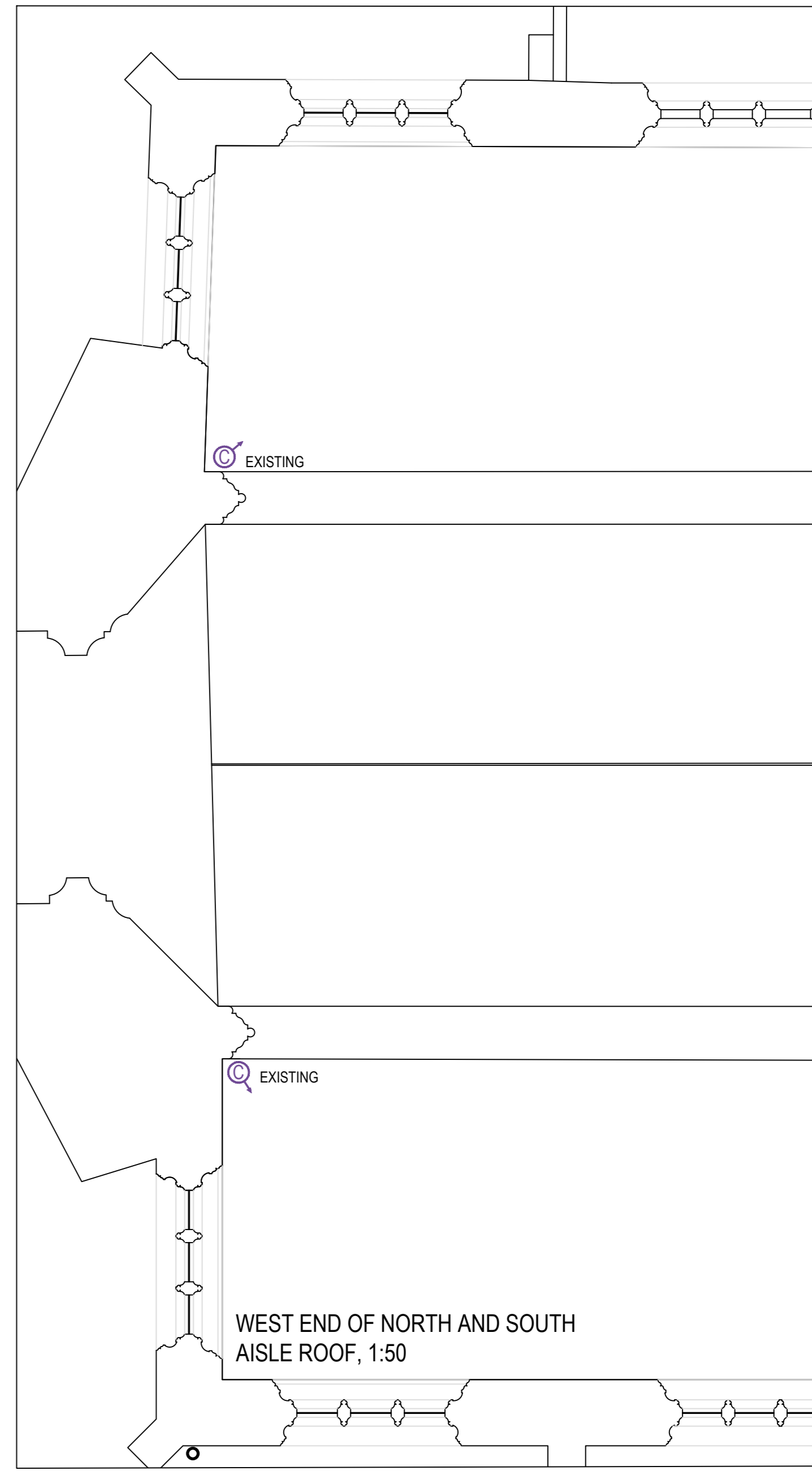
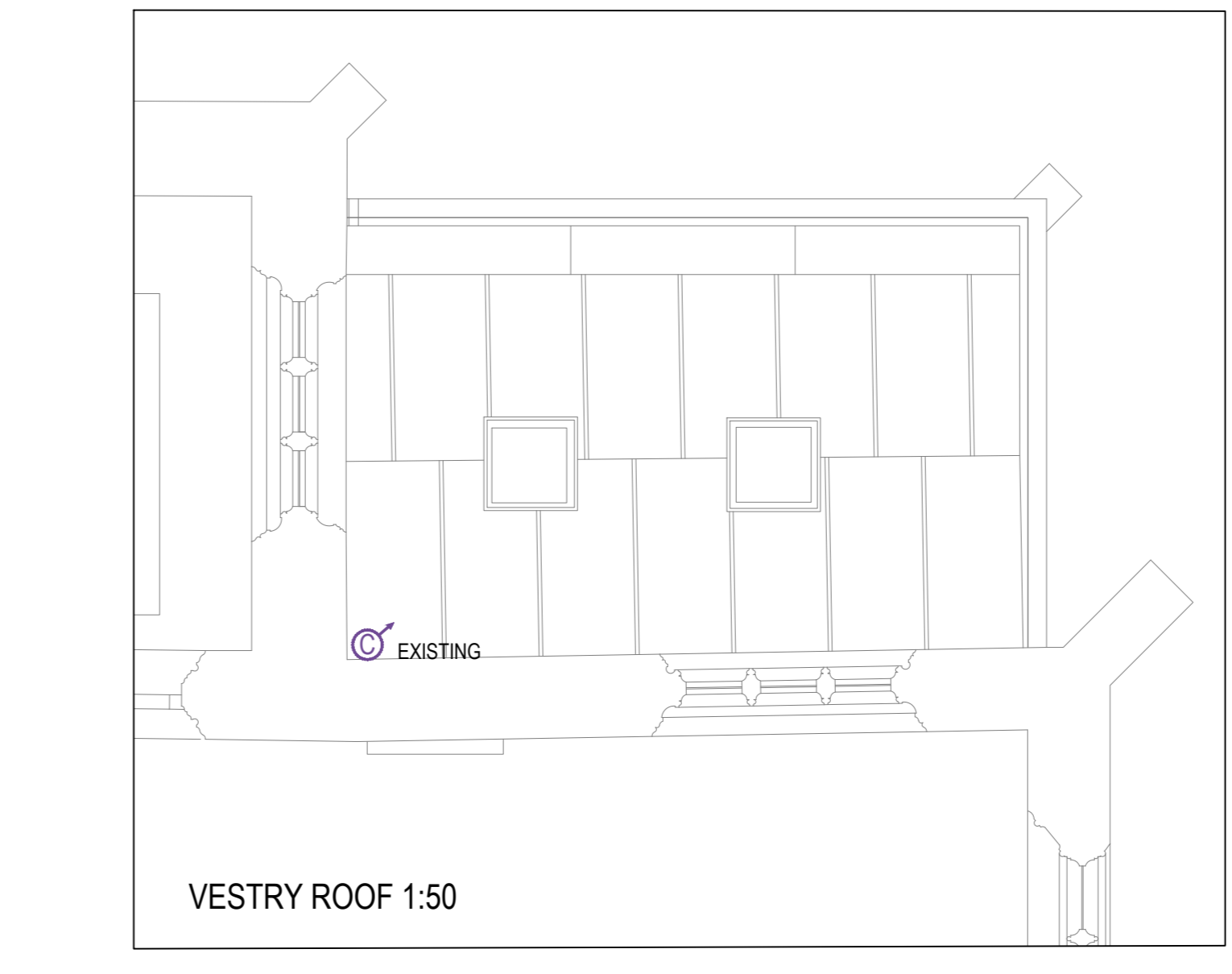

- NOTES**
1. THIS DRAWING SHALL BE READ IN CONJUNCTION WITH THE SPECIFICATION FOR ELECTRICAL SERVICES INSTALLATION AND ALL ASSOCIATED ELECTRICAL DRAWINGS LISTED THEREIN.
  2. ALL ELECTRICAL SERVICES DRAWINGS SHALL BE READ IN CONJUNCTION WITH ALL ASSOCIATED ARCHITECTURAL, STRUCTURAL, DRAINAGE AND MECHANICAL SERVICES DRAWINGS.
  3. THE CONTRACTOR SHALL CHECK AND VERIFY ALL DIMENSIONS ON SITE PRIOR TO COMMENCING CONSTRUCTION.
  4. ASBESTOS MAY BE PRESENT IN ANY PART OF THE BUILDING. THE ASBESTOS REGISTER SHOULD BE CONSULTED PRIOR TO ALL WORKS, AND ALL SITE OPERATIVES SHALL BE TRAINED IN ASBESTOS AWARENESS.

EXISTING WALL MOUNTED DOME CAMERA TO BE CAREFULLY REMOVED FOR RE-USE IN A NEW POSITION.

NEW CAMERA TO BE POSITIONED TO OVERLOOK SAFE ONLY AND BE PROGRAMMED TO RECORD AT NIGHT ONLY.

EXISTING HIKVISION NVR TO BE REPOSITIONED FROM CHURCH COTTAGE

INTRUDER ALARM HEAD END EQUIPMENT / POWER SUPPLIES WALL MOUNTED ABOVE BOOK CASE.

EXISTING WALL MOUNTED DOME CAMERA TO BE CAREFULLY REMOVED FOR RE-USE IN A NEW POSITION.

REV	DATE	DESCRIPTION
P1	10/10/22	PRELIMINARY FOR COMMENT



ENVIRONMENTAL  
ENGINEERING  
PARTNERSHIP  
CONSULTING ENGINEERS  
www.eep.co.uk  
01494 464 544

CLIENT	ST LAWRENCE CHURCH PCC
PROJECT	PROJECT INSPIRE ST LAWRENCE CHURCH LECHLADE
TITLE	SECURITY SYSTEMS LAYOUT

DRAWN	KH / IP	SCALE	1:50 @ A0
CHECKED	IP / PQ	DATE	AUG 2022
DRAWING No.	4184 E 03	REVISION	P1