

KEY FLOOR FINISHES

- New stone with underfloor heating below
- New stone with no underfloor heating
- New hard wearing non-slip vinyl
- New suspended timber
- New carpet (laid over retained tiling)

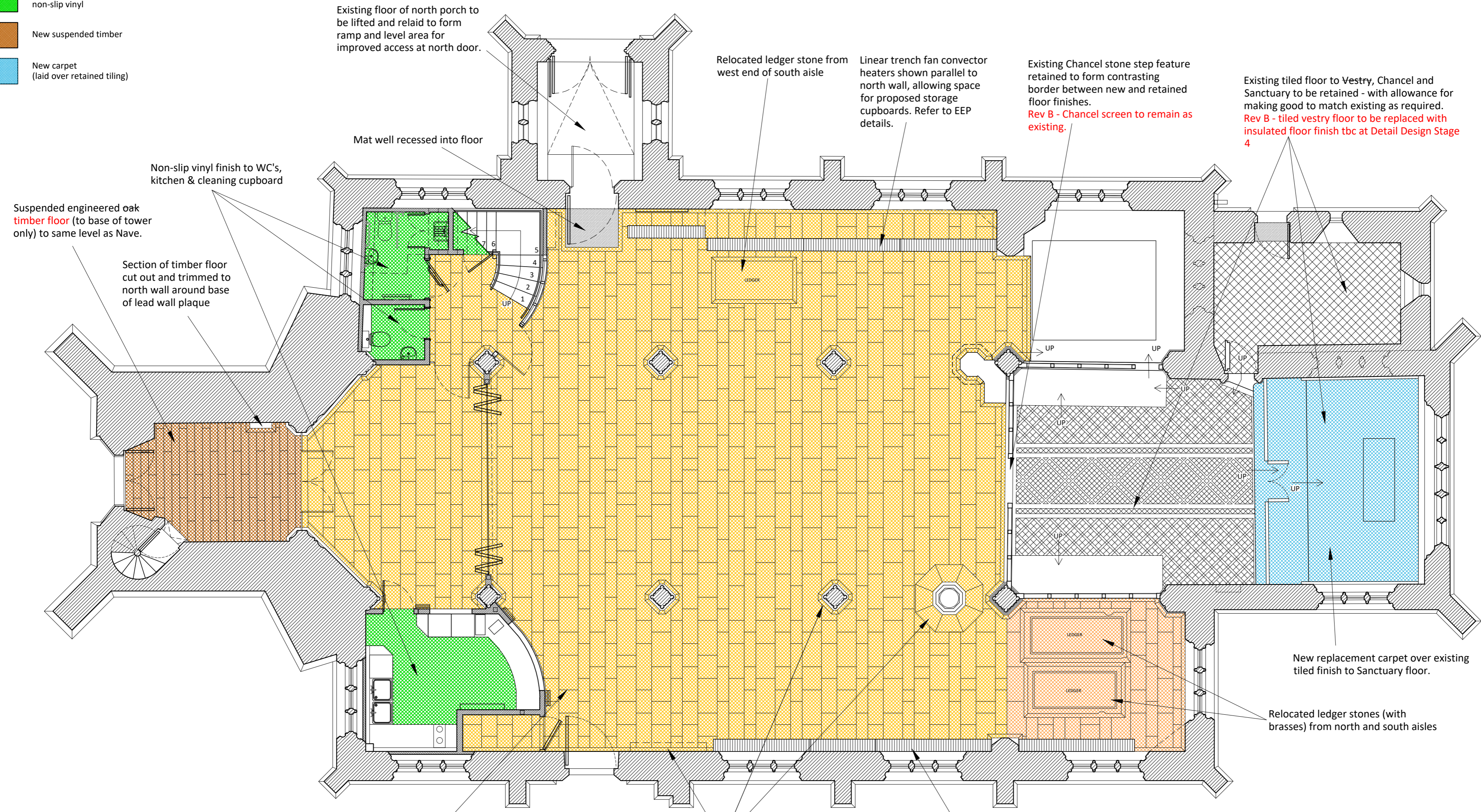

Existing floor of north porch to be lifted and relaid to form ramp and level area for improved access at north door.

Relocated ledger stone from west end of south aisle

Linear trench fan convactor heaters shown parallel to north wall, allowing space for proposed storage cupboards. Refer to EEP details.

Existing Chancel stone step feature retained to form contrasting border between new and retained floor finishes.
Rev B - Chancel screen to remain as existing.

Existing tiled floor to Vestry, Chancel and Sanctuary to be retained - with allowance for making good to match existing as required.
Rev B - tiled vestry floor to be replaced with insulated floor finish tbc at Detail Design Stage 4

Non-slip vinyl finish to WC's, kitchen & cleaning cupboard

Mat well recessed into floor

Suspended engineered oak timber floor (to base of tower only) to same level as Nave.

Section of timber floor cut out and trimmed to north wall around base of lead wall plaque

New replacement carpet over existing tiled finish to Sanctuary floor.

Relocated ledger stones (with brasses) from north and south aisles

New Purbeck limestone floor to main body of church (nave, aisles, tower) where floor raised - to be level with Chancel. Stone flooring laid in variable widths and lengths as shown indicatively.
Rev B - Decorative motif to be included to break up expanse of new stone floor - tbc at Detail Design Stage 4.

Contrasting border of stone tiles laid around column bases, wall perimeters, font and pulpit.

Linear trench fan convactor heaters shown along south wall. Refer to EEP details.

B | 1st Sept23 Minor amendments following feedback from DAC to include chancel screen remaining, decorative motif to new nave floor and vestry floor to be renewed.
A | 22.12.22 Updated with client amendments

CHEDBURN • CODD
CONSERVATION ARCHITECTS
Historic Building Consultants

Glove Factory Studios, 1 Brook Lane, Holt, Bradford-on-Avon, Wiltshire BA14 6RL
T: 01225 859999 www.chedburn.com e: chedburn@chedburn.com

Project	St Lawrence Church Lechlade	
Drawing	Floor Finishes As Proposed	
Stage	RIBA Stage 3	
Drawing No.	Scale	Date
1922/024/B	1:75 @ A2	Aug 2022