

'LORD God of Israel, there's no god like you in heaven above or on earth below. You keep the covenant and show loyalty to your servants who walk before you with all their heart.'

Solomon dedicates the temple in Jerusalem (1 Kings 8: 23)

PROJECT PRAYER

Almighty and faithful God, we thank you that in Jesus Christ You have called us to be members of your worldwide Church. We praise you for the Christian witness and worship of St. Lawrence church in Lechlade over many centuries. Help us to trust in You for our future and strengthen us in our ministry and service to others.

May you bless and prosper our 'Inspire' re-ordering project. May this building continue to be a place of inspiration, worship and comfort for all. May your truth be faithfully proclaimed as you draw all people to Yourself. We humbly ask these things through the grace and mercy of Jesus Christ, Your Son and our Lord. Amen.



PROJECT INSPIRE

For Future
Generations

ST. LAWRENCE LECHLADE
RESTORATION AND RE-ORDERING



PROJECT INSPIRE

**CONSERVING OUR HERITAGE
MAKING BOLD IMPROVEMENTS
CREATING WELCOMING SPACES
REDUCING OUR CARBON FOOTPRINT**

THE PROJECT PLAN

This brochure explains the Project Plan which will be presented to the Gloucester Diocesan Advisory Committee (DAC) for approval. It also details the cost of the project and asks for pledges to fund the project.

The project began in 2018 with a questionnaire to parishioners asking for their views on how to approach a much-needed restoration. Those views formed the basis of the 4 principles adopted by the Project Team in developing plans, together with conservation architects Chedburn Codd.

Draft plans were presented to parishioners in September 2021 for comment and feedback, and discussed in detail with the DAC and the statutory bodies appointed to evaluate projects like PROJECT INSPIRE. The plans have been modified to reflect that feedback, in the context of meeting the project's objectives, and they are now in the form where approval is sought from the Chancellor to grant a Faculty to proceed.

It is also now the appropriate time to ask parishioners, and interested Trust Funds, to support the project in the form of pledges to provide money over the next 2-3 years so that the project can proceed with the necessary funding assured. Please read this brochure carefully, look at the detailed drawings available in the church, ask whatever questions that occur to you, and fill in the form on the back page. Thank you and God bless.

INTRODUCTION BY ANDREW CINNAMOND, VICAR OF ST LAWRENCE



**JOIN WITH US AND BECOME A
PARTNER IN 'PROJECT INSPIRE'**

For many centuries the spire of St. Lawrence Church in Lechlade has been a landmark, a familiar and welcoming presence in the landscape. It is a marker both physically and spiritually, pointing people upwards to the reality of God and the Christian faith in the local community. The building is greatly loved and admired by many, as befitting its Grade 1 listed status. It is a haven of peace and tranquillity in a busy and often fractious world for those from any faith or none.

It is also a building whose interior has changed over the years - galleries have come and gone, the triple decker pulpit has certainly been diminished, the floor has been replaced, boxed pews were introduced and then in turn gave way to lighter pews, the font has been moved, a rood screen came and went, an organ was introduced and then moved etc. Things never stand still and the building has reflected momentous changes in the Church and in wider society. Like the generations before ours we have a duty to plan for the future and ensure we have the facilities and infrastructure for the generations that come after us.

More than five years ago the PCC began to think and pray about how the church building could be made into a more flexible and inviting space. This began a long process of seeking competent advice and listening to what people thought about St. Lawrence Church and what it could look like in the future. We consulted widely in the local area and invited people to come to presentations, ask all their questions and raise any concerns they might have. We visited other parishes to see good examples of craftsmanship and re-ordered church buildings. When our initial proposals were put to the community in September 2021 there was overwhelming support. We then listened carefully to concerns and objections and incorporated them into our plans, as far as possible without sacrificing the integrity of our key aims.

We are now at the stage of submitting our proposal to the Diocese of Gloucester for approval and beginning to raise funds for our Project Inspire. We realise that we are entering a time of real economic uncertainty as a nation and may take several years to raise the necessary funding. Works will only commence once we are confident that we have enough funding in place. At this time we are asking that the church family gets behind this project and for you to show your support by pledging whatever you can afford. It is an act of faith towards the future of our church and the wider community God has placed us in. The project is ensuring the future of a building that has been greatly used in the past and we pray will be wonderfully used by many future generations. Would you prayerfully consider how you can contribute financially towards the project? Full details will be found at the back of this leaflet.

This is a great opportunity to make a significant and lasting difference to our church family and its mission to our local community and the wider world. The costs are considerable, because the building is precious and all changes must be of the highest standard. However, thanks to the thoughtfulness and generosity of parishioners over the last 30 years we are able to fund around two thirds of the total cost, so we believe that the extra needed is achievable. We believe that we have an excellent project with clear aims and objectives, which will make a big difference to the experience of those who use the building.

- February 2023



OUR CHURCH BUILDING

Church buildings are more than just visible symbols of Christianity in our towns and villages. They provide the physical, material context for local groups of Christians to come together to worship God and to celebrate or remember key events in our lives. As worship changes over time, so too the church building changes. The people influence the building, just as the building influences the people. St. Lawrence, Lechlade is a church building whose interior shows evidence of many adaptations over its 550 year history.

There has been a church in Lechlade since the 13th Century. The existing perpendicular church was built of Taynton limestone and completed in 1476. The external structure is a fine example of a Grade 1 Cotswold wool church and has been relatively unchanged over the last six centuries. The internal layout has changed significantly during the same period, reflecting the liturgical needs of the church. In 1476 St. Lawrence was part of a wider Roman Catholic Europe where the Latin mass was the central act of worship. The momentous religious changes of the reformation in the second decade of the 16th Century, stripped the church and damaged artefacts. The physical building of St. Lawrence reflected these changes in theology and liturgical practice - pews were places for people to sit and primarily listen, empty niches were devoid of images and rood stairs leading nowhere reflect previous practices. For more than three hundred years there was no screen separating the chancel and the nave.

The Oxford Movement of the mid 19th Century felt the Reformation had gone too far, Protestant theology was damaging and the 'beauty of holiness' had to be restored in public worship. This meant substantial changes to the liturgical space of parish churches reflected in the 1882 reordering of St. Lawrence. Communion tables were turned back to altars again (and raised and railed off), vestments and hangings were re-introduced, as were new choir screens. The balance now swung back to sacramental worship, away from the preaching of God's Word.

The ritual of the Mass/Holy Communion was made more elaborate and focussed on what the priest did in the newly separated chancel area. The whole focus of the congregation was drawn to the raised altar at the east end. The Reformation was now partially reversed.

A parish church building today needs to be adaptable to differing forms of worship for a wide variety of members of the church family – from a more contemporary worship style, utilising advances in digital technology, to a quiet traditional Book of Common Prayer service; flexible seating arrangements to allow for a greater variety of styles of worship and wider community events than is currently the case; toilet and kitchen facilities, as well as meeting rooms, to enhance appeal to all ages. A warm, well-lit and welcoming space, retaining the natural beauty of the medieval structure, but without unnatural barriers between people, will greatly help in encouraging more people to use the church and in reaching the local community with the love of God in Jesus Christ.



▲ The 1828 reordering looking west - note the organ on the balcony, box pews and stone floor (higher than it is today).

OUR CHURCH TODAY

Residents of Lechlade _____ over 3000 and growing

Children at C of E Primary School _____ 200+

Number of adults on Church Suite communication database _____ 174

Regular attendance at Sunday services _____ 150 on average / 10 services a year with over 200

IRREGULAR SERVICES AND CHURCH EVENTS

Large services (e.g. Remembrance) and Christmas (x3) _____ 200+

School services several times a year _____ 200+

Weddings and funerals _____ 100+

WHEN WE ALREADY RE-ARRANGE THE CHURCH

Children's Holiday Club _____ 90+ inc. helpers

Ladies' breakfast _____ 60+

Harvest and Maundy meals _____ 50+

CONCERTS AND OTHER EVENTS

Lunchtime 'serenade and sandwiches' 6/year _____ 100+

Mission, concerts, Christmas carols and others _____ 100+



▲ Coffee after a regular 10am service.



▲ Remembrance Sunday.



▲ The Mission Concert.

▶ Set out for a ladies breakfast



BACKGROUND

In 2018 it became obvious that a significant amount of work was needed to remedy a number of issues with the fabric of St Lawrence Church caused by aging and 'wear and tear': specifically damage to the walls, particularly at low level where pipework and cabling have caused erosion; an old, unreliable heating system not capable of providing sufficient warmth in the winter; a floor being increasingly damaged whenever pews are moved; an electrical system in need of renewal; poor lighting and audio-visual facilities hindering services and events; draughts through doors; and leaking roofs.

The PCC felt that, given the amount of work and money that would be necessary to restore the building, it would be appropriate to ask for parishioners' views on what else might be done at the same time to fit the church for this and future generations. The initial consultation with the church community in the autumn of 2018 gave overwhelming support for creating open and welcoming spaces, providing access for all abilities, supporting worship and mission, and making flexible use of the building for all services, meetings and events. There was clear support for replacing pews with more comfortable/lighter seating, providing toilets for all abilities, and including a larger kitchen. The condition of our heating and lighting systems and the need for more effective audio-visual technology were identified as major drivers to equip the church building to new and evolving technologies to support worship and events.

Working with the DAC we decided to see if the church building could be adapted inside, to include all the facilities that are needed – integral accessible toilets, a kitchen, and meeting rooms. Instead of having to use the Church Cottage next door. Our conservation architects, Chedburn Codd, have achieved just that. The cottage has been a wonderful asset for the last 20 years; however, it is far from ideal, and in need of full renovation.

To improve comfort for church users, and to meet the Church of England target to reduce carbon emissions to zero by 2030, changes are required to the heating system. Following professional advice, underfloor heating powered by an air source heat pump and roof PV panels will help to meet this target.

The DAC has indicated it is content with the overarching principles of the proposed scheme and supported the presentation of plans to the community. We continue to work with the DAC on



▲ The damaged walls and old heating system ▲

THE MAIN ELEMENTS OF PROJECT INSPIRE

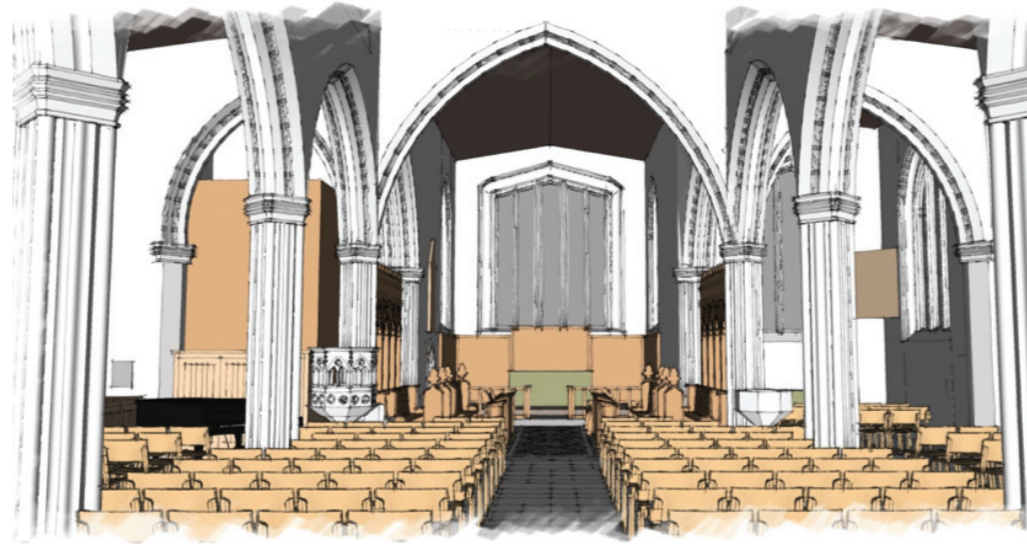

THE NORTH PORCH

This will revert to being the principal entrance. There will be new external doors, and draught-proof doors into the nave; the original wooden door will be retained.

THE FLOOR

A new level floor of high-quality finished limestone flagstones will be laid across the nave and the aisles to match the level of the existing floor in the chancel. This returns the floor to its original level (changed in the Victorian re-ordering) and allows for electrical and heating services to be channelled underneath.

THE PEWS

Replacement of all the heavy pews with seats to allow flexible seating.

THE GALLERY

At the west end of the church a gallery will be reinstated where one was in the 18th and 19th Century, with meeting rooms, kitchen and toilets below; the bell ringing chamber will be adapted to allow it to be used when not being used for bell ringing.

THE CHOIR AND PARCLOSE SCREENS

It is proposed to remove the choir screen to open the chancel into the body of the church as it was before the Victorian re-ordering.

THE CHANCEL

Unchanged but with the planned removal of the choir screen the glorious East window will be revealed.

An idea of what the church could look like, and how flexibly it could be used, was seen in September 2022 on the Sunday after the Children's Holiday Club when the pews had been temporarily removed. Without pews the large space in the nave and aisle would be much more flexible.



▲ Children's Holiday Club September 2022

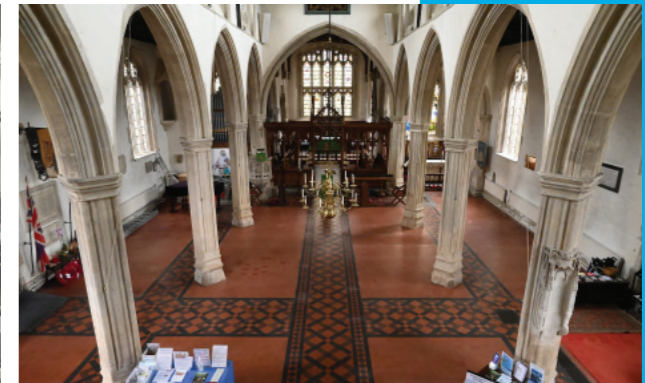

▲ The nave with all pews removed

THE NORTH PORCH

The return of the north porch as the main church entrance will provide a more welcoming light entrance. The porch was probably added to the church in the Elizabethan era and served as the main entrance to the church until the re-ordering of 1882.

Traditional solid timber external doors will safeguard the porch internals from the weather and allow the area to be used effectively. The provision of a level access from Shelley's Walk through the north porch and into the nave will allow unimpeded access for all abilities.

The fine original wooden door, from the porch into the north aisle will be retained and held permanently open. Light glass doors will allow normal access from the porch into the main church.



▲ existing closed north porch.



▲ Plan View with the external timber doors open, showing the level access created.



▲ Purbeck floor at St Giles and St Nicholas, Sidmouth (courtesy of Artorius Faber)

THE FLOOR

A new Purbeck limestone floor set at a higher level above the existing floor will provide a durable, lighter and welcoming open space with flexibility to use for all services and a range of church and community activities. This returns the floor level near to the pre-1882 reordering. The existing lime concrete floor will remain in place beneath the new floor.

The floor will enable level, step free, access for all abilities from all entrances to the communion rail; currently this is not feasible because of steps from the north porch and into the chancel; and is an opportunity to meet our statutory obligations regarding access.

Underfloor heating and insulation will be installed between the existing and new floor to deliver effective even heat across the nave and aisles, improving the comfort for church users. The underfloor heating will be powered from an air source heat pump. This will allow us to meet the Church of England target for carbon reduction by 2030.

Routing the services under the new floor will allow the removal of unsightly radiators and pipework and allow the walls to be restored to their original light colour, contributing to the open and welcoming aspect of the church. Power and data sockets will be installed at low level on the walls and on some pillars.

THE GALLERY

The west gallery will be reinstated on generally the same alignment as the previous gallery which was removed in the Victorian re-ordering. This will have a floor at the same level as the existing bell ringing chamber and will provide additional seating. Beneath the gallery there will be two toilets, one for disabled users. The enclosed kitchen proposed for beneath the south-west corner of the gallery will replace the small units currently installed in the north-west corner of the north aisle which are open to the nave. There will be serving hatches to the nave and to the central meeting room.

A singing gallery was located at the west end during the 18th century. A re-ordering in 1828 shows galleries at the west end and along the north aisle, one of the defining features of that time. The plans show an organ and 'organ loft' at the rear of the gallery. Both the west and north galleries were dismantled as part of the 1882 reordering. The organ was moved to the north-east chapel around the same time.

The proposed gallery will be mainly self-supporting and will not significantly affect the existing structure. The area below the gallery will include a central meeting room with sliding doors into the nave. This will allow room for discreet meetings or to be part of the nave seating. Continuing to the south, a door will open into the kitchen, fully equipped for serving drinks and light meals for regular and one-off church events such as coffee after services, harvest supper, concerts, children's holiday club and so on.



▲ Plan View at gallery level looking north

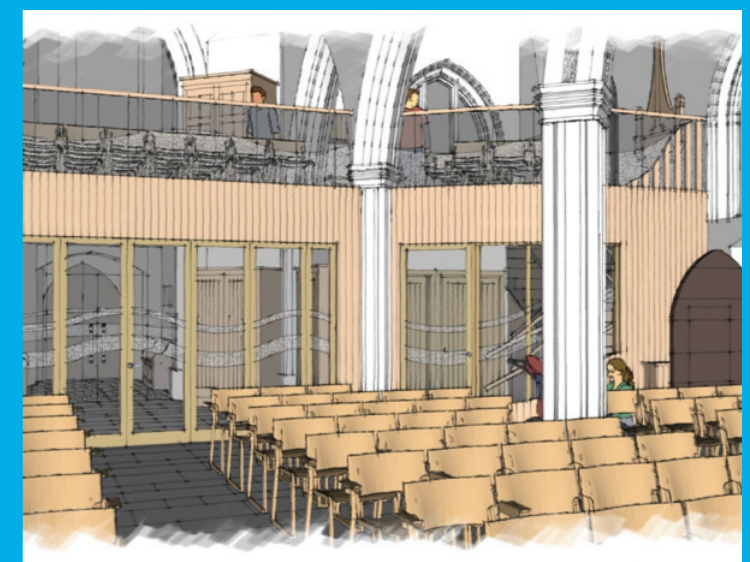

▲ Plan View of the new gallery from the south

**THE FOLLOWING CHANGES
HAVE BEEN MADE TO THE PLANS
SINCE THE SEPTEMBER 2021
CONSULTATION**

The lobby inside the north porch has been removed so as not to intrude into the nave. We now request that the choir screen be removed rather than re-located to the gallery. The Blaise chapel in the SE corner will be retained for small services and quiet prayer.

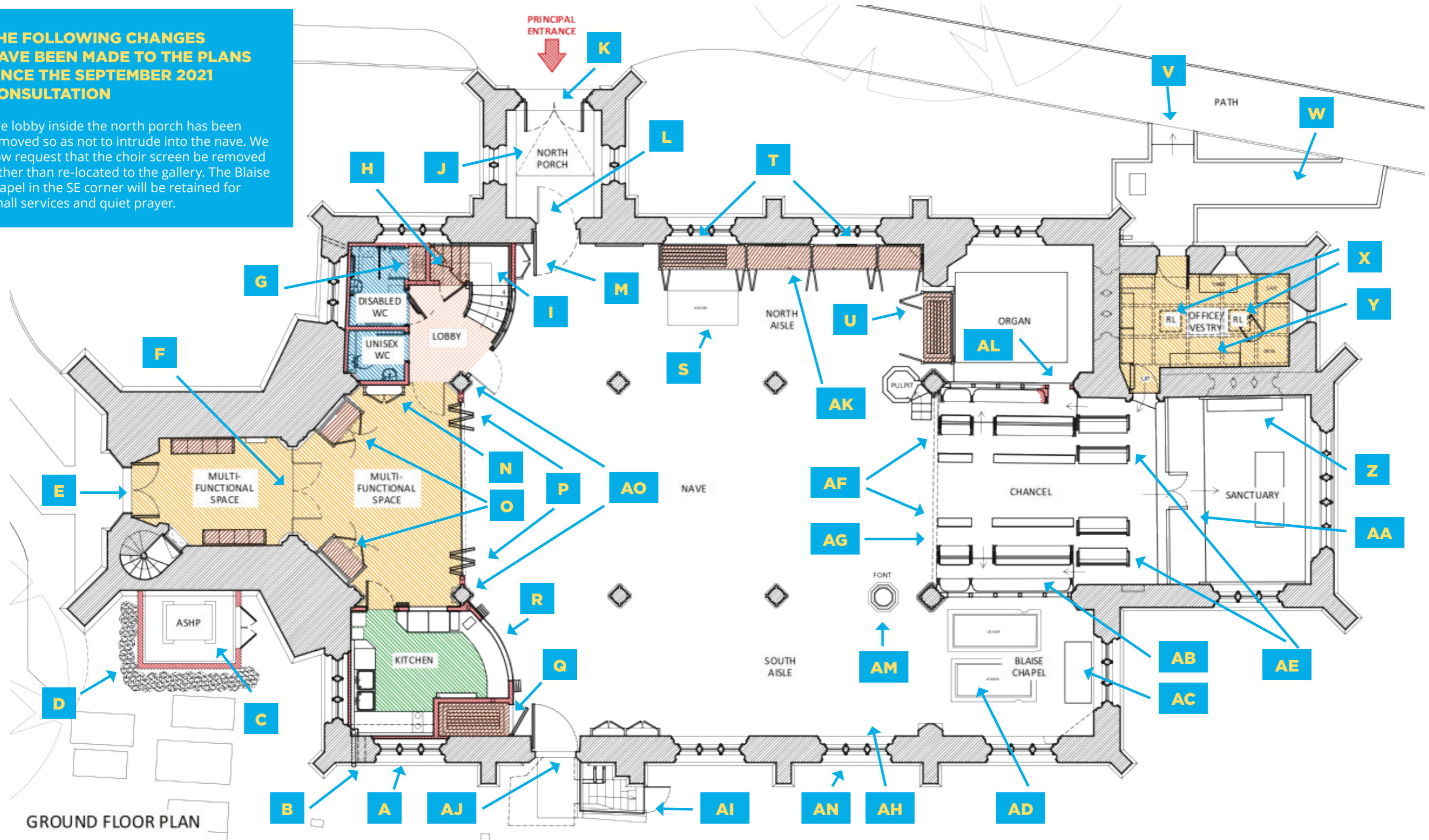

GROUND FLOOR PLAN

- A** Stained glass window relocated to E of S aisle
- B** Extractor fan
- C** Air Source Heat Pump with acoustic surround
- D** Evergreen hedge
- E** W entrance for special occasions
- F** Glazed screen and doors
- G** Cleaner's sink/storage
- H** Storage under stairs
- I** Staircase to gallery
- J** Floor re-laid for ramped access

- K** Gates replaced by traditional solid wooden doors
- L** New glazed door
- M** Old door to be kept open
- N** Oak cupboard for electrical equipment
- O** Oak cupboards for Sunday School and Little Lights
- P** Folding glazed doors
- Q** Storage cupboard for tables
- R** Kitchen to follow line of gallery
- S** Ledger stone
- T** Low level storage cupboards

- U** Storage for tables
- V** New path and steps
- W** New path with level access
- X** New rooflights
- Y** Cupboards
- Z** Altar frontal box relocated from Blaise chapel
- AA** Existing chancel tiled floor to be retained
- AB** Chancel screen retained
- AC** Remove reredos and relocate altar table
- AD** Relocated ledger stones with brasses
- AE** Four existing pews to be relocated in the chancel

- AF** Choir pews/frontals retained
- AG** Existing choir screen to be removed
- AH** Linear trench fan heaters along base of wall
- AI** Boiler room
- AJ** S door restored as alternative exit
- AK** Linear trench fan heaters in front of cupboards
- AL** Opening to access organ: screen retained
- AM** Font relocated from W end
- AN** Plain leaded light replaced with stained glass from SW
- AO** New self-supporting gallery across W end



▲ View of nave during a service, showing existing pew arrangements



▲ The chairs to replace the bench pews



▲ When the pews are moved once a year for the Children's Holiday Club, the space becomes open for many types of events – this is our vision for St Lawrence: flexible to a wide variety of needs; for whatever the community may need in the future from its church.

THE PEWS/SEATING

The objective of having an open and flexible area for worship and events is currently constrained by the existing pews. These are uncomfortable, confirmed by the 2018 consultation, and very heavy to move. This is a significant issue for those having to move the pews, and a major constraint on the ability to provide flexible space for current and future activities.

The bench pews were installed as part of the 1882 re-ordering, replacing box pews constructed as part of the reordering in 1828. The existing deal pews with plain ends cover the whole nave and aisles extending to the west door and the south chapel. Whenever these heavy pews have to be moved they risk damaging the floor tiles; much damage has already been done. We may retain a small number of pews to address comments from the DAC and amenity societies.

The pews will be replaced with light modern chairs of a design popular in many churches which have re-ordered recently; in the 2021 consultation parishioners overwhelmingly preferred this design to the five others presented. The removal of the pews meets the objective to provide flexible use of the building for services and community events.

We hope that parishioners will wish to sponsor the chairs at the cost of £250 each, with the names of the sponsors being recorded in the Project Inspire Memorial Book.

The new chairs will be linked to maintain rows and row ends will have arm rests. The design allows for them to be easily stacked when not all of them are in use (for example at Ladies' Breakfasts). They will be easy to clean.

The use of chairs will allow a more flexible arrangement for services and events such as concerts and where tables are used.

THE CHANCEL

The chancel will remain as it is, apart from the proposed removal of the choir screen.

THE SOUTH CHAPEL

This is the Blaise chapel which was consecrated in 1954. Prior to 1954, bench or box pews were fitted in the area. The chapel will continue to be used, mainly for Holy Communion services and quiet prayer. The reredos will be removed to provide greater space. The new floor level will continue into this area.

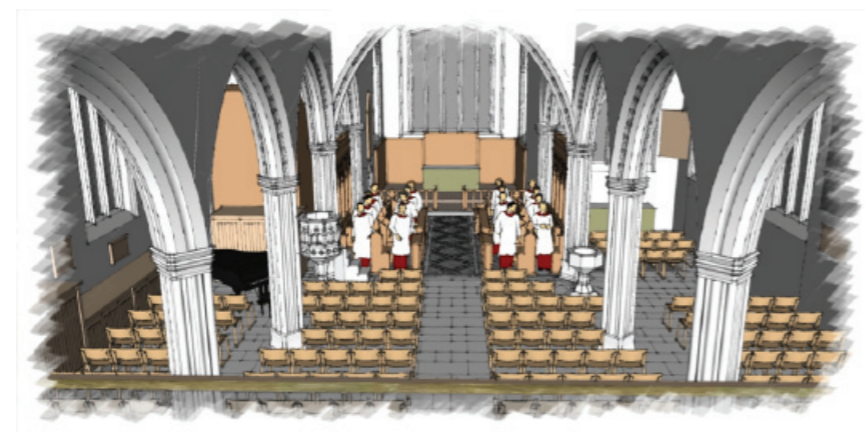

▲ Plan View of the chancel and sanctuary looking east from the gallery

Following investigations and advice from the church buildings conservator, the two large ledgerstones with brasses, currently at the east end of the nave (and not in their original location), will be moved to the new floor in this side chapel area. The lower footfall in this area will help to conserve the brasses.

The Lazarus window lights this area, and is particularly beautiful in the early morning sun. The proposal will enhance this feature while providing discreet storage cupboards at a low level and relocating historic chests. Under normal use, the area can be used for quiet prayer while providing discreet storage under the altar and in relocated historic chests.

THE CHOIR AND PARCLOSE SCREENS

For the three centuries between the Reformation in the 16th Century and the 1882 re-ordering the space between the nave and chancel was clear with an unobstructed view of the altar, the officiating priest and the east window. Simon Jenkins in his book on England's Thousand Best Churches comments that 'a heavy Victorian screen shields the chancel and thus obstructs the view of the East window'. There was strong support from the initial 2018 consultation for relocating the screen which would provide a clear aspect to the chancel and sanctuary.

The prevailing view of the present worshipping community is that we should seek to remove barriers between the clergy and congregation, as we are all the People of God. Holy Communion is open to all as a sign of God's grace and welcome. This stance differs from a more sacramental Anglo-Catholic ecclesiology of Victorian times which sought to emphasise the distancing between laity and clergy. This removal of the screen returns the area to the pre-1882 reordering where for three centuries there were no physical barriers between clergy and congregation. The screens are not listed in the Grade I historic record.

Although we recognise that the choir and parclose screens are of good quality and that it would be good to retain them in the re-ordering in some form, our initial proposal to relocate the choir screen was rejected. So we are now asking permission to remove the choir screen altogether. The key issue here is opening the chancel to the nave to expose the beautiful east window and to integrate the chancel into the main body of the church, thereby creating a light, more welcoming and flexible space. This will allow the installation of a drop-down screen behind the chancel arch, a great improvement on what is now possible, and essential for effective modern services and for events.



▲ Townsend ledgerstone



▲ Lazarus window

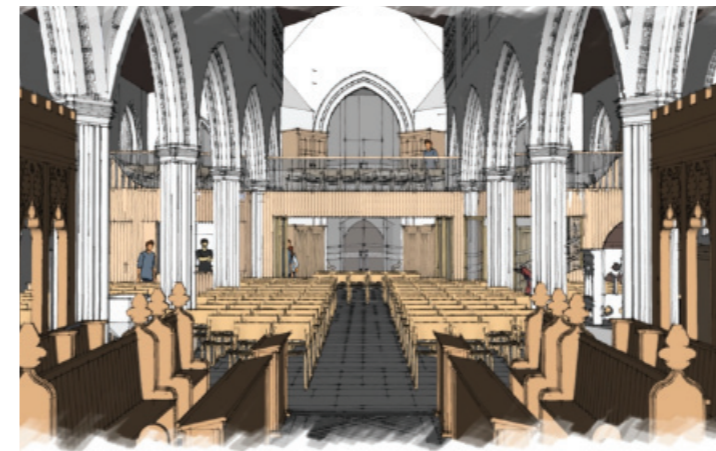

▲ Plan view with the choir screen removed: the space looks much larger.

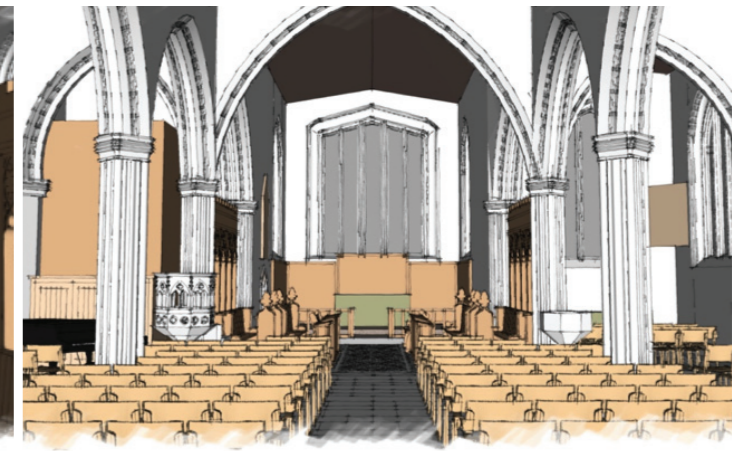

▲ Plan view Looking east with the choir screen removed, allowing an un-interrupted view of the magnificent east window

OTHER ELEMENTS OF THE PROJECT

THE WEST PORCH

The west porch will be a multi-use area suitable for Sunday school and other meetings. The floor will be raised to the new level of the nave with a timber insulated floor and painted walls to lighten the room. The west door, to be more weather resistant, will be opened for use on occasions such as weddings and funerals. Externally the hard landscaping will be raised to provide step free access to the west door.

THE BELL RINGING CHAMBER

The bell ringing chamber will be reconfigured so that it can be used as an occasional meeting room without affecting its prime use for bell ringing which is a key part of the church's heritage and function. Glass doors within the stone arch will separate the room from the balcony. The room will also be used as a meeting room when ringing is not taking place. Bell ropes will be secured when not in use.

THE FONT AND PULPIT

The font will be moved to the east of the nave and opposite the pulpit. This will provide greater visibility as new members of the church are baptised. The pulpit will be raised to meet the new floor level.

LEDGERSTONES

Investigations have confirmed that the three ledgerstones are not in their original locations. We propose to move two to the Blaise chapel in the south aisle, and the Bathurst ledgerstone will be located near to the war memorial where the footfall is low.

THE SOUTH DOOR

The door was sealed for many years and has suffered from the prevailing weather. Evidence suggests this was the original door and was well used in earlier times. We propose to restore the door and replace fittings for use as an additional exit.

THE VESTRY AND PARISH OFFICE

This will be used as the parish office during the week and as a vestry on a Sunday and for other services. The external door will be made accessible for all and used for everyday use. Having a parish office so readily accessible is a major improvement over the current situation where the office is upstairs in the cottage (see THE PRACTICALITIES on opposite page 14). The room will have two skylights fitted to make it a more pleasant place in which to work.

MONUMENTS

A small number of memorials will be moved as they would otherwise be obscured by the balcony.

AUDIO VISUAL TECHNOLOGY

There is increasing need to provide audio visual technology to support our services and mission. Ideally we would wish to install a central drop-down screen behind the chancel arch (if we can remove the choir screen), mobile screens in the north and south aisles and arrangement in the meeting rooms, creating the flexibility needed for all types of services and events.



▲ the AV screen at St Dionysius, Market Harborough very similar to our proposal

CARBON REDUCTION

The Church of England's General Synod in February 2020, set new targets for all parts of the church to work to become carbon 'net zero' by 2030. Clearly, this is a challenge for such an old and historic building.

HEATING

Heating our lofty church building is a challenge. A higher floor level provides the opportunity to include effective insulation and install underfloor heating. Heat distribution will be more effective using underfloor heating and trench heaters along the perimeter of the north and south aisles.

An air source heat pump (ASHP) is to be located just outside the south door. It can extract heat when air temperatures are as low as -5°C although at lower efficiency. The output temperature is lower than gas boilers and is more suitable for underfloor heating. The ASHP will be powered by renewable electricity purchased from the grid. Solar panels are also likely to be installed on the south-facing roofs of the south aisle and the south side of the nave.

LIGHTING

The installation of new lighting not only offers an opportunity to reconfigure the layout of the building for the various uses of the church but also enables low energy systems to be adopted. The much longer life of LED type lamps reduces our maintenance burden too. New lighting will provide a softer white light that is brighter (more lux) yet uses less energy and thus contributes to the national goal of reducing our impact on the environment.

THE PRACTICALITIES

The PCC currently owns the cottage next door to the church building; this was purchased some 20 years ago through the generous funding of the church community. It has proved an invaluable resource for children's and other groups, for meetings, for a church office, for its kitchen and toilets. However it is now in need of considerable maintenance expenditure (which would require fund-raising) to maintain fitness for purpose. The church office is not accessible to all parishioners, the toilets are not suitable for those with limited mobility, and access to upper floors is difficult.

The plan for St Lawrence envisages all the facilities of the cottage being integrated into the church – a highly desirable feature of a building in use by large numbers of people in today's world. As a consequence, the

cottage can be sold to provide some of the funding for Project Inspire. Providentially, the cottage has increased in value above the rate of inflation, rewarding the faithful who provided for its purchase, and its sale will fund the re-ordering part of Project Inspire.

Restoration and the provision of modern, efficient, eco-friendly heating and lighting will however require additional funding. The church community has wisely been raising money over many years to provide for restoration and had accumulated £200,000 by the end of 2022, and spent a further £35,000 to take the plans to the current design stage. That leaves a gap between the budgeted future costs and the current resources available. Details as follows –



"We believe that responding to climate change is an essential part of our responsibility to safeguard God's creation. Our environmental campaign exists to enable the whole church to address — in faith, practice and mission — the issue of climate change"

- Church of England

BUDGETED COST OF PROJECT INSPIRE

RESTORATION
FACILITIES
RE-ORDERING
CONTINGENCY

£950,000
£350,000
£250,000
£350,000
£100,000

Cottage proceeds cover the cost of re-ordering

SOURCES OF FUNDS

SALE OF THE COTTAGE
RAISED TO DATE
ALREADY SPENT ON DESIGN
SHORTFALL NEEDED TO BE RAISED
CONTINGENCY

£350,000
£200,000
£35,000
£365,000
£100,000

BUDGET COSTS

■ RE-ORDERING
■ FACILITIES
■ RESTORATION
■ CONTINGENCY

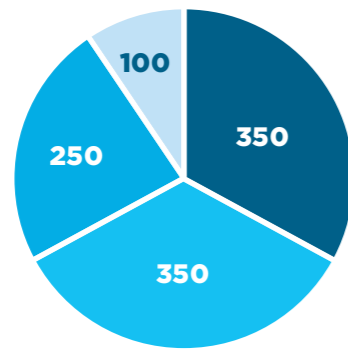

The building work can be completed within 12 months, so for that time church activities would have to be accommodated elsewhere (predominantly at the Memorial Hall). That cost, the threat of inflation on building costs and other contingencies result in the need to be sure of at least another £465,000 to be able to deliver Project Inspire.

So the plans are fully developed, costed, and ready for approval. At this stage we ask for the support of parishioners in the form of pledges to provide money to enable the project to proceed. At the same time a number of Trust Funds, known to be willing to support projects like ours, will be approached for their support: we hope to attract around 25% of our needs from Trust Funds but that leaves the need for the majority of the additional funding to come from the community of Lechlade itself.

Pledging can take many forms – and whatever is most appropriate for individuals can be accommodated.

A ONE-OFF LUMP SUM ONCE THE PROJECT STARTS (MOST LIKELY IN 2024)

A SERIES OF AMOUNTS SPREAD ACROSS THE DURATION OF THE PROJECT (MOST LIKELY 2024)

Most donors will be able to claim Gift Aid, which allows us to receive a further 25% of each donation from HMRC. **So if we can achieve pledges from individuals of over £290,000 we will be as good as there!** The experience of many other parishes shows that donations will range from £100 or less to £10,000 or more. To be completely open, we hope that our donation profile from individuals will be as shown in this chart.

We are seeking enough pledged support to be able to commission the project once a faculty has been granted by the Chancellor. We appeal to the church community and wider parish to see the benefits in restoring our wonderful heritage building at the same time as fitting it for future generations of parishioners for the many and varied uses for which they will wish to use it.

There is never a good time to ask for donations and clearly these few years are going to be particularly difficult. Bearing this humbly in mind, we ask simply

SOURCES OF FUNDING

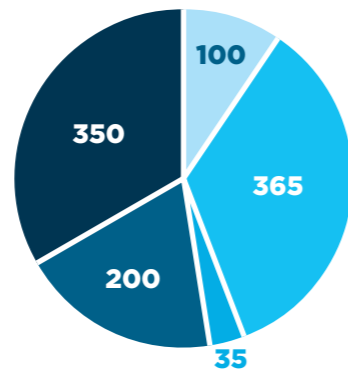

■ CONTINGENCY
■ SHORTFALL
■ SPENT
■ RAISED TO DATE
■ COTTAGE

for parishioners to consider carefully whether they can afford to donate following the Christian principle of 'to each according to his means'. If you can afford to donate it will be valued enormously by all those who use this church now and in the future.

The cost of the chairs, which will replace the pews and make the church so much more flexible, is included in the Budget Costs above. However, you may wish to treat their funding separately by sponsoring a chair for its cost of £250. We will record all the sponsors in the Memorial Book recording the achievement of Project Inspire.

TIMING

We hope to be able to commence construction works during early 2024. Once sufficient pledges have been received, plans can be made to relocate church activities temporarily, the cottage can be marketed, and construction lead times accommodated.

THANK YOU

The PCC of St Lawrence, the Project Inspire Team, and the parishioners of Lechlade (present and future) thank you most sincerely for your support, for your wish to preserve our wonderful heritage, and for your faith in the future. May God bless your generosity.

DISTRIBUTION OF DONATIONS

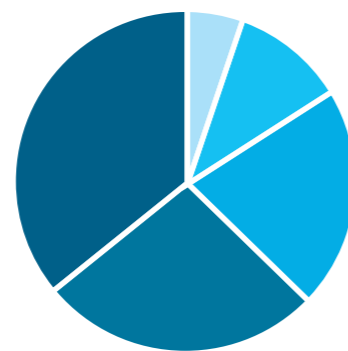

■ UP TO £500
■ 500-1000
■ 1000-5000
■ 5000-10000
■ OVER 10000

ALL DONATIONS WILL, OF COURSE, BE WELCOMED EQUALLY BUT, REALISTICALLY, REACHING THE TARGET WILL DEPEND ON A RELATIVELY SMALL NUMBER WHO ARE ABLE TO DONATE LARGE SUMS

PLEDGE FORM

YOUR DETAILS

I (full name) _____

of (address) _____

Post Code _____ Tel No. _____

email _____

HOW YOU WISH TO PLEDGE

I pledge to provide the sum of £_____ when the construction works start, at the request of the PCC Treasurer.

OR

I pledge (delete as appropriate) a series of payments when the construction works start, at the request of the PCC Treasurer, according to the following schedule -

Monthly for _____ months the sum of £_____

OR

Quarterly for _____ quarters the sum of £_____

OR

Year 1 the sum of £_____ and Year 2 the sum of £_____

OR

please specify your preferred schedule

SPONSORING THE CHAIRS

I also wish to sponsor _____ chair(s) at the sum of £250 each.

GIFT AID DECLARATION

I am a UK taxpayer and expect to be able to make a Gift Aid declaration when my donations are requested. The PCC Treasurer will ask for a Gift Aid declaration at the appropriate time. A Gift Aid declaration allows the PCC to claim from HMRC an additional 25% on top of your donation.

Signed by _____ Date _____

This is not a legal commitment; it is a pledge made in good faith on which the Project Inspire Team and the PCC can rely when deciding whether to proceed with Project Inspire by commissioning the building contractors.

ILLUSTRATION

Donating £10/month for 2 years would total £240: quarterly donations of £50 over 2 years would total £400. With Gift Aid these amounts are increased by HMRC, the PCC receiving £300 and £500 respectively. Assuming that you are eligible for Gift Aid - Donating £20/month for 12 months would total £240 to which HMRC would add £60 for a total of £300 towards Project Inspire. Donating £100/quarter for a year would total £400 to which HMRC would add £100 for a total of £500 towards Project Inspire.

Please detach this back page and place in the dedicated Project Inspire box at the back of the church or post to the PCC Treasurer, Church Cottage, Market Place, Lechlade GL7 3AB

If you have any questions regarding Project Inspire or the pledging process please email parishofficelechlade@gmail.com leaving your contact details, and someone will be in touch.





▲ Plan View of the room at the west end and the hatch to the kitchen

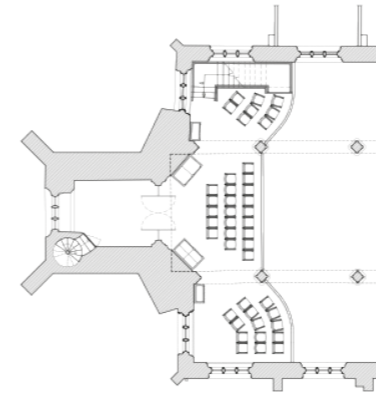

First Floor Plan
Seating Option 1A

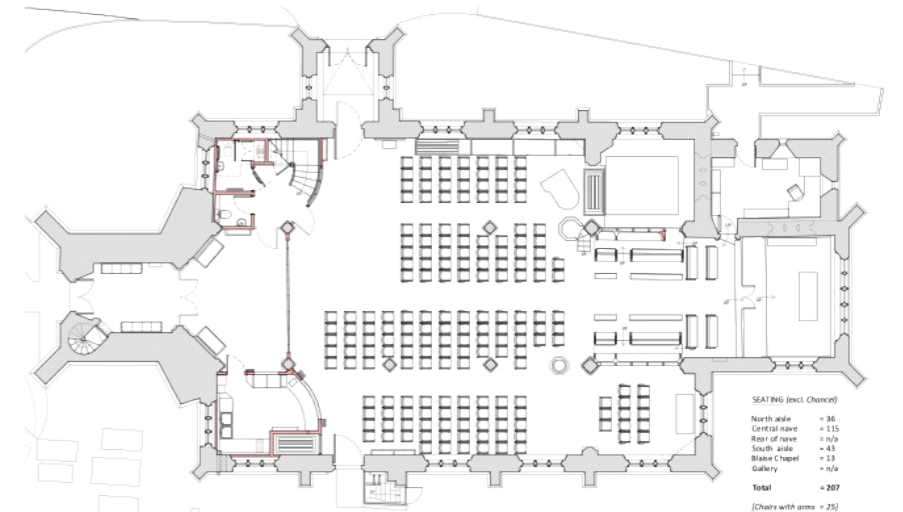

Ground Floor Plan
Seating Option 1 - Traditional East Facing (typical)

PROJECT INSPIRE

Alternative seating arrangements, possible when chairs replace pews.

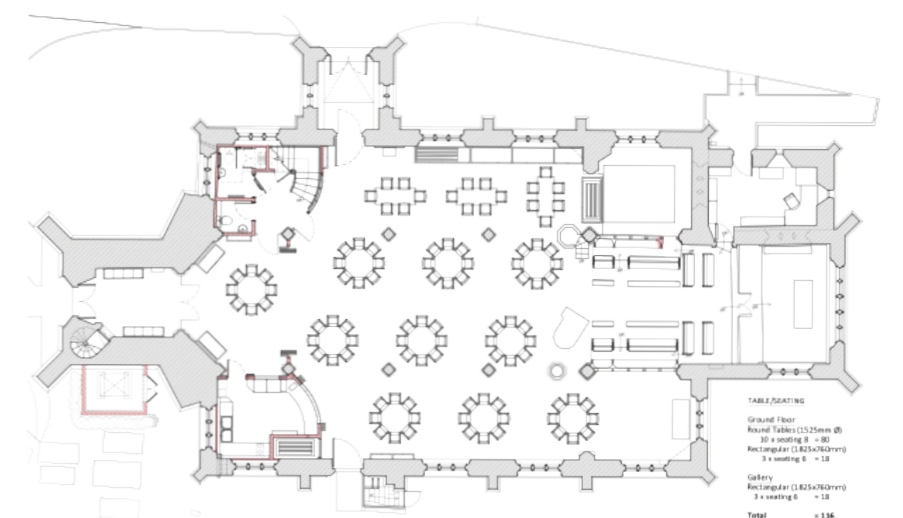

Ground Floor Plan
Seating Option 5 - Events (Tables)